

 **kikka boo**

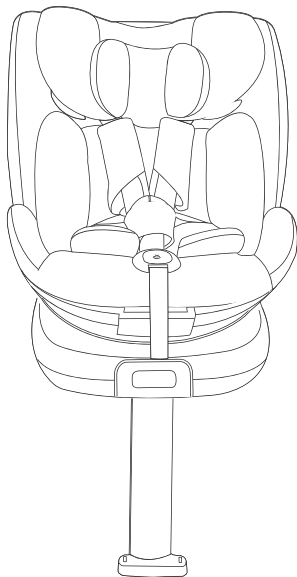

**40-150cm**

**i-TWIST** 

car seat  
i-SIZE

<b>EN</b>	INSTRUCTIONS FOR USE	<b>BS</b>	UPUTSTVO ZA UPOTREBU
<b>ES</b>	INSTRUCCIONES DE USO	<b>KA</b>	გამოყენების ინსტრუქცია
<b>BG</b>	ИНСТРУКЦИИ ЗА УПОТРЕБА	<b>ME</b>	UPUTE ZA UPOTREBU
<b>IT</b>	ISTRUZIONI D'USO	<b>UA</b>	ІНСТРУКЦІЯ З ВИКОРИСТАННЯ
<b>GR</b>	ΟΔΗΓΙΕΣ ΧΡΗΣΗΣ	<b>HR</b>	UPUTE ZA UPORABU
<b>DE</b>	GEBRAUCHSANWEISUNG	<b>CZ</b>	NÁVOD K POUŽITÍ
<b>FR</b>	MODE D'EMPLOI	<b>SK</b>	NÁVOD NA POUŽITIE
<b>NL</b>	GEBRUIKSAANWIJZING	<b>SL</b>	NAVODILA ZA UPORABO
<b>FI</b>	KÄYTTÖOHJEET	<b>HU</b>	HASZNÁLATI UTASÍTÁS
<b>RO</b>	INSTRUCȚIUNI DE UTILIZARE	<b>HY</b>	ՕԳՏԱԳՈՐԾՄԱՆ ՑՈՒՑՈՒՄՆԵՐ
<b>PT</b>	INSTRUÇÕES DE USO	<b>ET</b>	KASUTUSJUHEND
<b>MT</b>	ISTRUZZJONIJIET GHALL-UŻU	<b>LT</b>	NAUDOJIMO INSTRUKCIJA
<b>PL</b>	INSTRUKCJA UŻYTKOWANIA	<b>LV</b>	LIETOŠANAS INSTRUKCIJA
<b>SR</b>	УПУТСТВО ЗА УПОТРЕБУ	<b>FA</b>	دستور العمل استفاده
<b>MK</b>	УПАТСТВА ЗА УПОТРЕБА	<b>AR</b>	تعليمات الاستخدام
<b>AL</b>	UDHËZIMET E PËRDORIMIT		



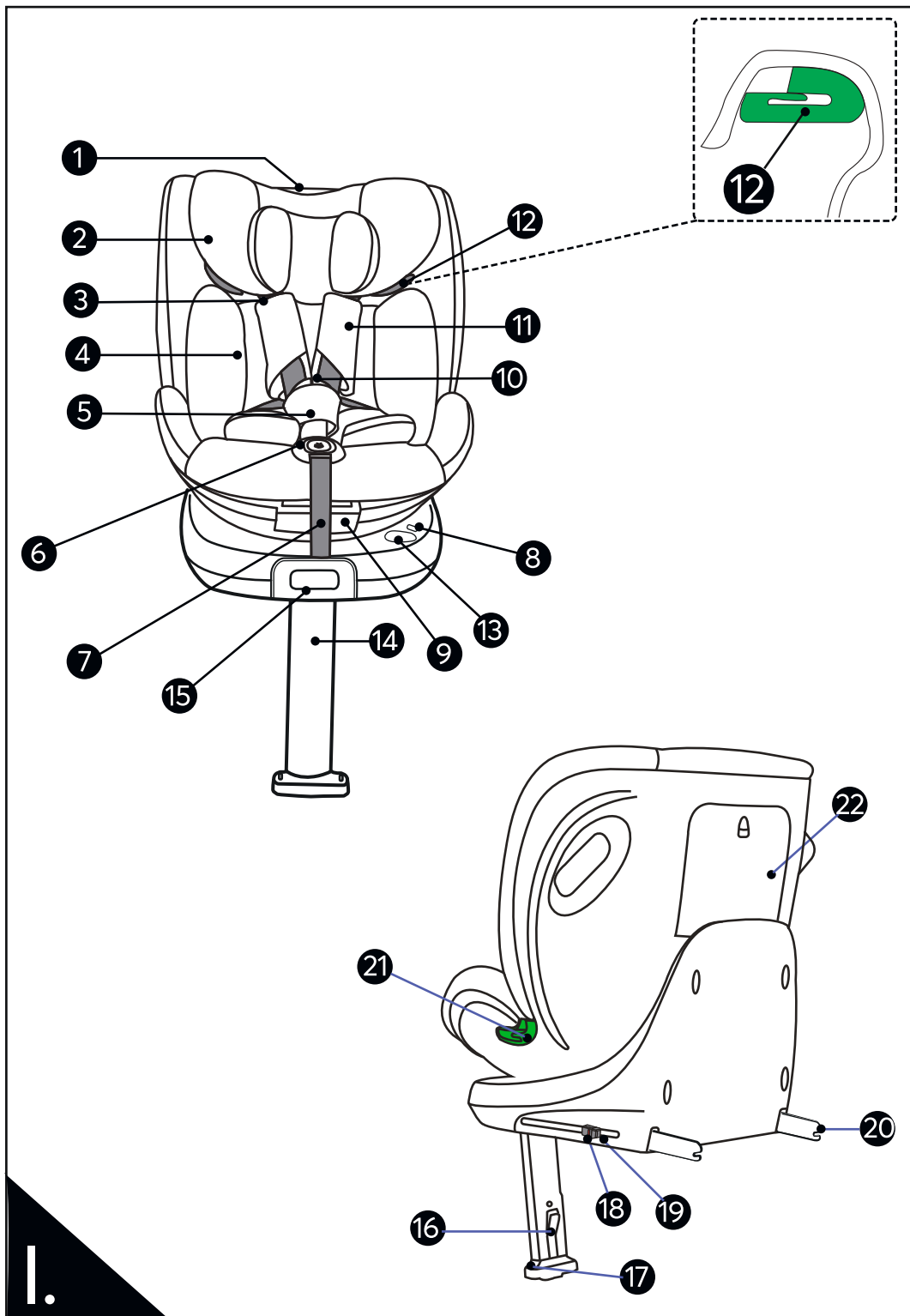

1



2

2.1

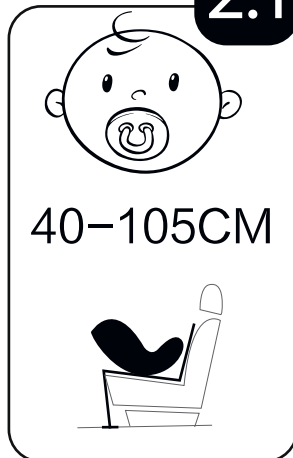

ISO/R2

2.2

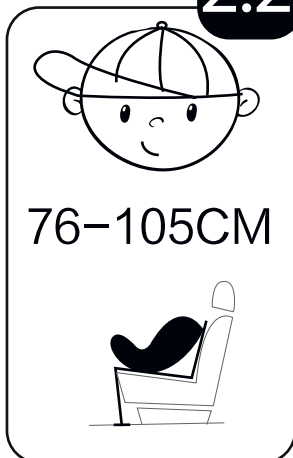

ISO/F2X

2.3

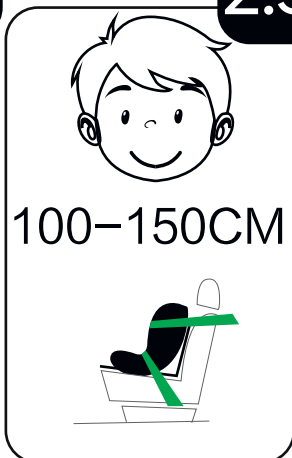

ISO/B2

3.1

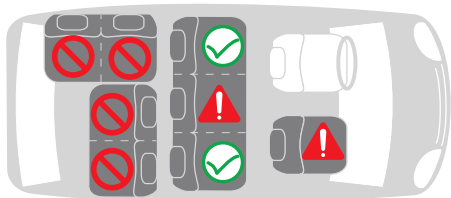

3.2

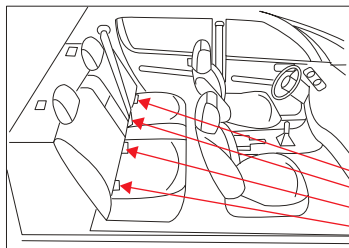

4

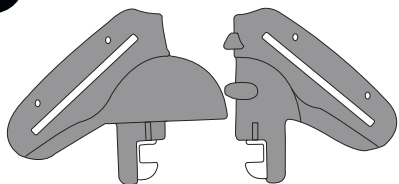

4.1

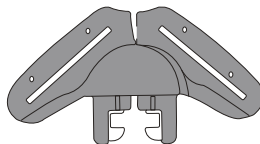
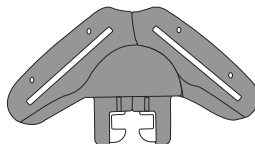

4.2

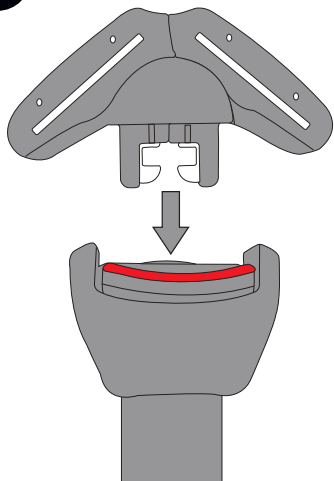

4.3

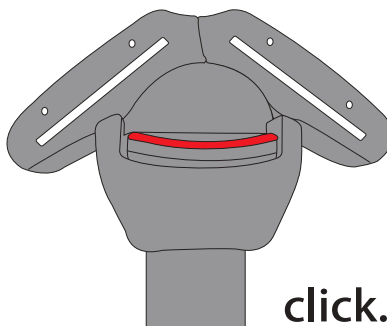

click...

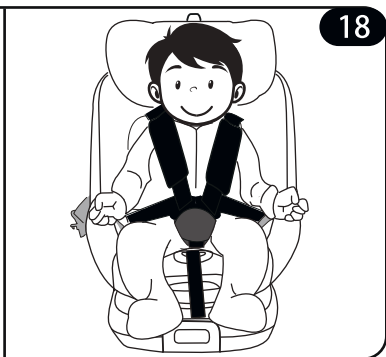
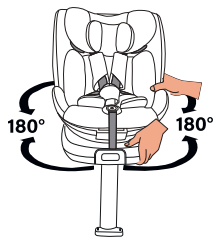
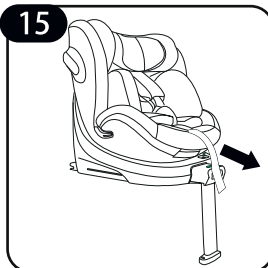
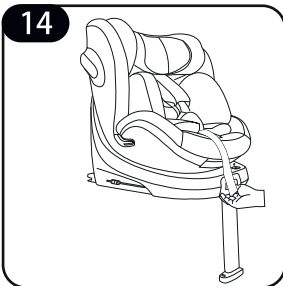
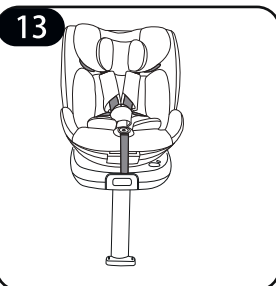
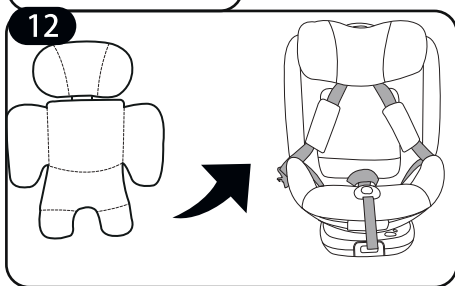
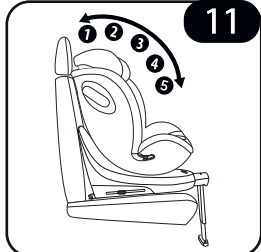
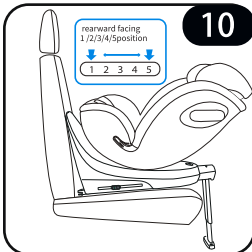
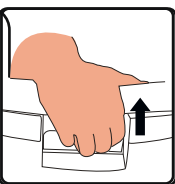
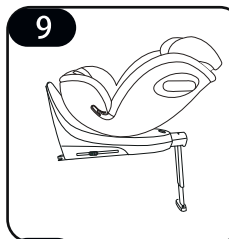
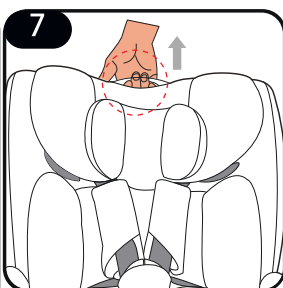

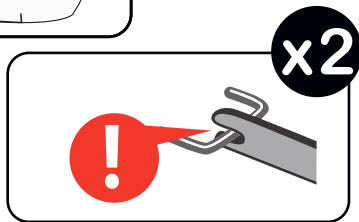
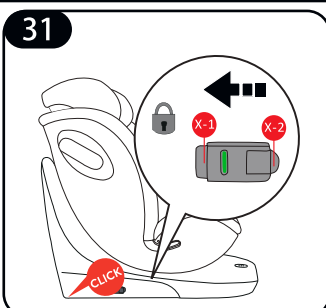
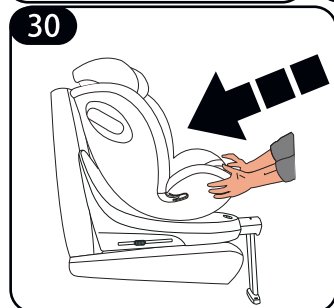
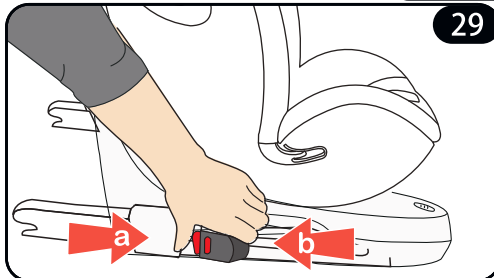
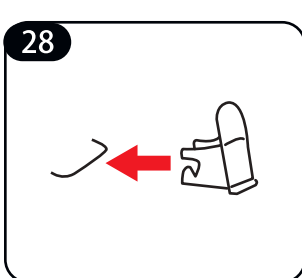
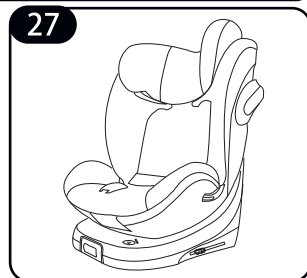
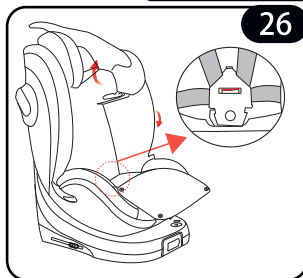
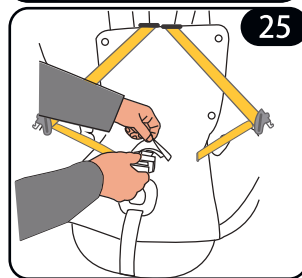
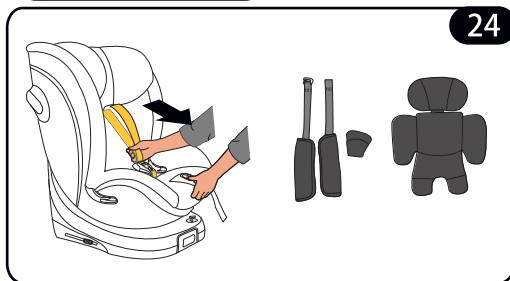
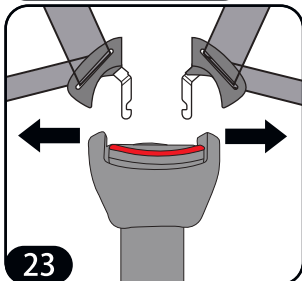
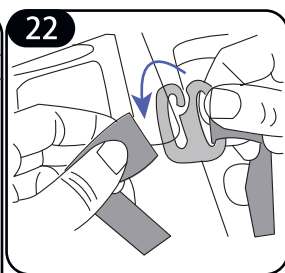
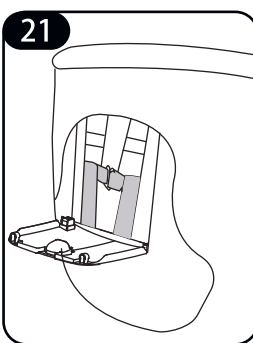
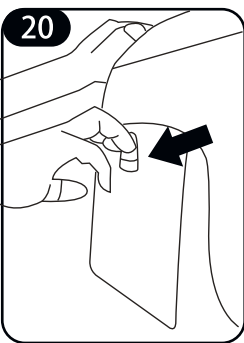

32

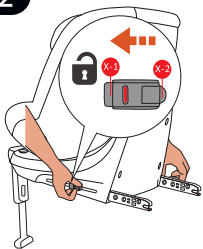

33



34

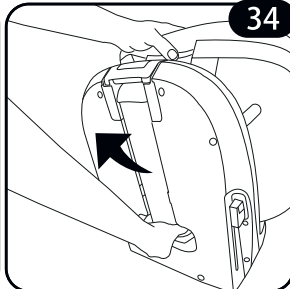

35

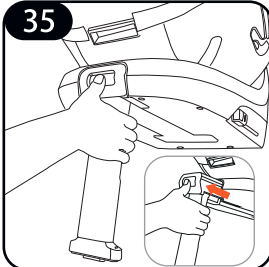

36



37

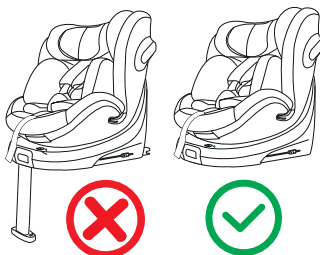

38

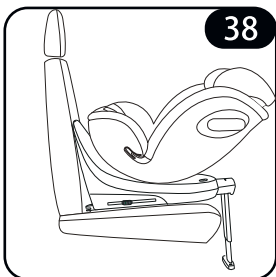

39

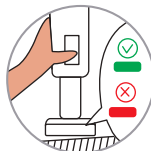
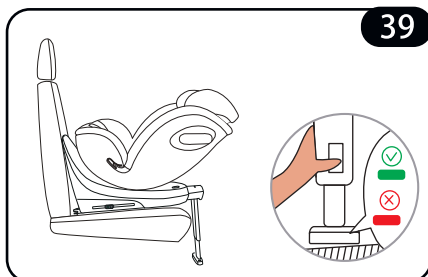

40

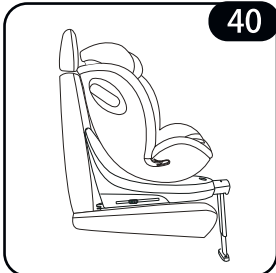

41

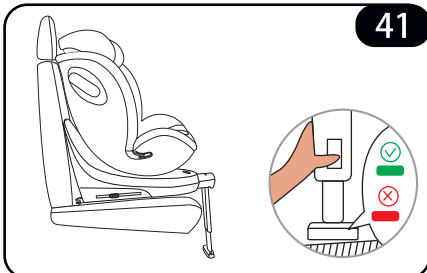



42

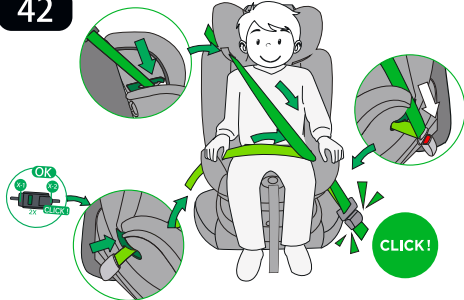

43

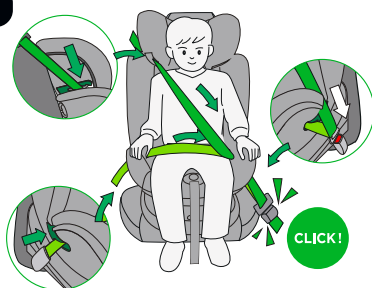

44



45

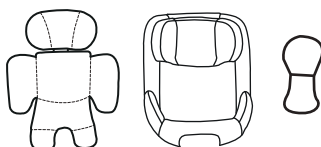
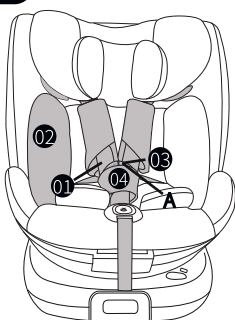

46

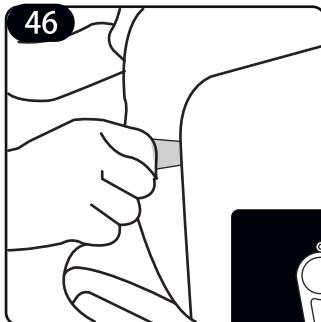

47





	Trade name of vehicle	Vehicle model(s)
1	ALFA ROMEO	156 Cross Wagon Q4, 156 Sportwagon, MiTo
2	AUDI	A1, A1 Sportsback, A2, A3 (5 doors), A3 (3 doors), A3 Sportsback, A3, A3 (facelift), A4, S4, RS4, A5, A5 Cabrio, S5 Cabrio, A5 Cabrio, A5 Sportback (5 doors), A6, S6, A6 Allroad Quattro, A6 Avant, A7 Sportsback (4 seats), A7 Sportsback (5 seats), A8, S8, Q3, Q5, Q7, TT, TT Roadster
3	BMW	5 series, 5 GT, 5 Touring, 6 series, 6 Coupe, 6 GranCoupe, 7 series, M5, Mini, Mini 2, Mini Club Man, Mini Countryman, X1, X3, X5, X6, Z4
4	CADILLAC	CTS
5	CHEVROLET	Aveo, Aveo Hatchback, Captiva, Cruze SW, Epica, HHR, Lacetti, Matiz, Nubria, Orlando, Spark, Volt
6	CHRYSLER	Crossfire, 300 C, Grand Voyager, PT Cruiser, Sebring, Voyager, Voyager Shown Go
7	CHRYSLER DODGE	Caliber, Journey, Nitro, Ram (1500/5 doors)
8	CHRYSLER JEEP	Cherokee, Grand Cherokee, Commander, Wrangler
9	CITRO ËN	Berlingo I, Berlingo II, Berlingo III, Berlingo Multi Space, C1, C2, C3 Pluriel, C3 Picasso, C3, C4 II, C4 Aircross, C4 Picasso, C4 Picasso, C4 Grand Picasso, C4 Grand Picasso, C5 Break, C5, C6, C8, C-Crosser, DS3, DS4, DS5, Jumpy, Nemo
10	FIAT	Bravo (Typ 198), Croma, Doblo, Dublo II, Fiorino Qubo, Freemont, Idea, Multipla, Panda, Punto (Typ 188), Punto (Typ 199), Punto EVO, Grande Punto, Stilo, Stilo Multi Wagon, Scudo 2, Ulysse
11	FORD	C-MAX, Grande C-MAX, Fiesta (MK7/5 doors), Focus, Focus Turnier, Focus Turnier, Galaxy, Kuga, Maverick, Mondeo, Mondeo Turnier, Mondeo Turnier, S-MAX, Tourneo Connect, Transit/Transit Connect, Transit Kombi
12	HONDA	Accord (4+5 doors), Accord Tourer (5 doors), Accord Tourer, City (4 doors), Civic 9, CR-V, FR-V (6 seats), Jazz (5 doors), Pilot
13	HYUNDAI	Getz, H-1 Travel, i10, i20, i30+i30cw, i40, i40cw, ix20, ix35, ix55, Matrix, Santa Fe, Sonata, Sonica, Sonata, i40, Terracan, Tucson
14	JAGUAR	S, XJ
15	JEEP	Grand Cherokee, Wrangler Unlimited
16	KIA	Carens, Carnival, Cee'd, Pro Cee'd, Cerato, Magentis, Opirus, Picanto, Picanto, Picanto (3 doors), Rio, Rio (5 seats), Sedona, Sorento, Soul, Sportage, Venga
17	LANDROVER	Discovery2, Discovery3, Discovery (facelift), Freelander 1, Freelander 2, Range Rover, Range Rover Evoque, Range Rover Sport
18	LEXUS	CT 200h, iS, GS 450h, RX 300, RX 350, RX 400h
19	MAZDA	2 series, 3 series, 5 series, 6/Atenza Kombi, 6 Sport Kombi, CX5, CX7, MPV, MX5 (Typ NB/2 seats), Premacy



20	MERCEDES BENZ	A class, B class, C class, C(W204/S204), C Coupé, C (Model T), CL class, CLS class, CLS(C218) class, E class, E(W211/S211), E(C207/W212/S212), E(A207), E Cabrio(A207), G(W463), GL, GLK, M, ML, R(W251/V251), S, Vaneo, Viano, Viano, Viano fun, Vito
21	MITSUBISHI	Colt(5 doors), Grandis, i-MiEV, Lancer Kombi, Lancer, Outlander, Pajero V80, Shogun
22	NISSAN	Almera, Cuba(Z12), Juke, Maxima(A33), Micra(K11), Micra(K12), Micra(K13), Micra Cabrio, Murano, Navara, Note, Pathfinder, Pathfinder(R51), Pixo, Primera (P11) Traveller, Primera (P12), Qashqai, Qashqai+2, Tiida, X-Trail
23	OPEL	Agila B, Ampera, Antara, Astra, Astra J, Astra J GTC, Astra J Sport Tourer, Astra Twin Top, Combo C, Corsa C, Corsa D(5 doors), Corsa (4 doors), Insignia, Insignia Sports Tourer, Meriva, Meriva B, Signum, Vectra, Zafira A, Zafira B, Zafira B, Zafira C Tourer
24	PEUGEOT	1007, 206cc, 206SW, 207CC, 208, 307, 307SW, 307 SW (5 doors), 308, 308 CC, 308 SW, 308 SW, 3008 Crossover, 4007, 4008, 508, 508 SW, 5008, 807, Expert, Partner (5 doors), Partner Tepee
25	PORSCHE	Cayenne, Panamera
26	RENAULT	Cilo III, Cilo Grandtour III, Espace, Grande Espace, Fluence, Kangoo, Kangoo be bop, Koleos, Laguna III, Laguna Grandtour, Laguna Grandtour III, Megane Cabrio, Megane, Megane II, Megane III, Megane III GrandtourModus, Modus, Grand Modus, Scenic, Scenic II, Scenic III, Grand Scenic, Traffic, Twingo, Twingo II, Vel Satis
27	SEAT	Alhambra, Altea FR/XL/Freetrack, Arosa, Exeo, Exeo Kombi, Exeo ST, Ibiza(6J), Ibiza(6K), Leon, Mii, Toledo M1, Toledo
28	SKODA	Citigo, Fabia II, Felicia, Octavia, Octavia II, Octavia II, Octavia II, Octavia Tour, DriveRoomster, Superb, Superb II, Superb Kombi, Yeti
29	SMART	Forfour, fortwo, fortwo II
30	SUBARU	Forester, Impreza, Legacy, Outback, Trezia, Tribeca
31	SUZUKI	Alto, Ignis, Jimmy, Kizashi, Splash, Swift, SX4, Vitara, Wagon R
32	TOYOTA	Auris, Auris Hybrid, Avensis, Avensis Verso, Avensis Combi, Aygo, Corolla, Corolla Verso, iQ, Land Cruiser 120, Land Cruiser (J12), Land Cruiser V8, Land Cruiser, Prius+, Prius 3, RAV 4, Urban Cruiser, Verso S, Yaris (5 doors), Yaris III
33	VOLVO	C70, S40, S60, S80, V50, V60, V70, XC70, XC80, XC90
34	VW	Amarok, Beattle, Bora, Caddy, CC, EOS, EOS, FOX, Golf IV, Golf IV, Variant, Golf V, Golf V (R32), Golf V Variant, Golf Cabrio, Golf V Plus, Golf VI, Golf VI Cabrio, Golf VI R, Golf VI Variant/Plus, Lupo, Passat, Passat B7 Altrack, Passat B7 Variant, Phaeton, Polo, Polo V, Cross Polo IV, Cross Polo V, Scirocco III, Sharan, Sharan II, T4 Caravelle CL/GL, T4 Multivan II, T5 Multivan, T5 Caravelle, T5 Caravelle (long version), T5 Kombi, T5 Kombi (long version), Tiguan, Touareg, Touareg II, Touran, Touran Cross, Up



35	Tianjin Xiali	TJ7101AE3, TJ7101ALE3, TJ7101AUE3, TJ7101AULE3, TJ7101BE3, TJ7101BLE3, TJ7101BUE3, TJ7101BULE3, TJ7141AE3, TJ7141ALE3, TJ7141AUE3, TJ7141AULE3, TJ7141BE3, TJ7141BLE3, TJ7141BUE3
36	BYD	F0, F3, F3R, G3, G3R, ,G5, G6, S6, S7, F3DM, E6, L3, M6, F6, S8
37	Great Wall	C20R, M2, C30, C50, M4, C70, M1, H6, H8, H1, H2,
38	Geely	MR7131D, MR7150B4, MR7151B4, MR7151EA4, MR7152D, MR7180D, MR7181, MR7181B1
39	Lifan	LF7130F, LF7131B, LF7132B, LF7152, LF7162B, LF7162E
40	Haima	7161, 7162, 7163, 6480, Haima 3, M2, M3, M5, M8, M6, S6, S7
41	Beijing auto	BJ20, BJ80, S2, S3, S6, H3, H2, H6, D20, CC, D50, D60, D70, D80, X25, X65, X55, M20, M30, T205-D
42	FODAY	F16, F22, F128
43	GAC	GA3, GA5, GA6, GS4, GS5, , GX5, GX6, GL, GP150, G3, G5
44	LANDWIND	X5, X7, X8, X9, X6
45	CHERY	E3, E5, M7, A3, A5, X1, G2, M1, M5, G3, G5, G6
46	ZOTYE	Z700, SR7, E30, Z100, Z300, Z500, T200, X5, T600, V10, E20, E200, T300, M300, Z200

# IMPORTANT! KEEP FOR FUTURE REFERENCE! READ CAREFULLY!

The instructions for use must be kept for the entire life of the universal child restraint system.

## WARNING

1. This car seat provides optimal safety in all installation positions for which it was designed.
2. This is an i-Size Enhanced Child Restraint System (40–105cm). It is approved pursuant to European Regulation 129 ( ECE R129 ), for use in i-Size compatible car seats as indicated by manufacturers in the car owner's manual. If you have questions, please consult either the Enhanced Child Restraint System manufacturer or the distributor.
3. This is an i-Size booster Enhanced Child Restraint System (76–105cm). It is approved according to ECE R129, for use in i-Size compatible seats, as indicated by the manufacturer in the car owner's manual. If you have questions, please consult either the Enhanced Child Restraint System manufacturer or the distributor.
4. This is a booster seat (100–150cm) and is an Enhanced Child Restraint System. It is approved according to European Regulation R129, for use primarily in i-Size seating positions. If you have questions, please consult either the Enhanced Child Restraint System manufacturer or the retailer.
5. This is an i-Size Universal child restraint system, approved pursuant to European ECE R129, for its general use in cars, although it is not suitable for all cars.
6. It should be installed in cars for which the manufacturer states in its car owner's manual that the vehicle is suitable for an i-Size Universal child restraint system for this age range.
7. The product has been approved pursuant to European regulation ECE R129 and can be used for heights between 40 and 150 cm and maximum weight 36 kg.
8. Make sure that the buckle is correctly fastened before starting to drive.
9. Any straps holding the restraint to the vehicle should be tight, that any support-leg should be in contact with the vehicle floor, that any straps or impact shields restraining the child should be adjusted to the child's body, and that straps should not be twisted.
10. Ensure that any strap or belt that holds the child is not folded or twisted and remains tightened.
11. Ensure that the abdominal belt or strap rests as low as possible over the child's hips, on both sides.
12. In the event of an accident, even if there are no apparent damages, the seat may be unsafe. The seat should be replaced after being subjected to the sudden and strong stresses associated with an accident.
13. Instructions illustrations are for informational purposes only. The child restraint system may contain small differences compared to the photographs or images in the instructions manual. These variations do not affect its approval by Regulation ECE R129.
14. Under no circumstances should the car seat be installed in the car's passenger seat opposite the direction of travel if there is an active airbag.
15. Please read the instructions carefully, as incorrect installation could result in serious injury. In this case, the manufacturer shall not be held liable.
16. Ensure that all the locking devices are engaged before use.
17. It is dangerous to undertake any changes or additions to the safety seat with approval from the competent authority. It is dangerous to not strictly follow the installation instructions provided by the child car set manufacturer.
18. Please never use the safety seat without its cover or without the harness protectors.
19. Make sure to protect the child safety seat from direct sunlight as it could heat up and hurt the child.
20. The car seat should remain permanently installed in the vehicle, even when the child is not in it. Never leave the child unattended when sitting in the car seat, even when the seat is outside the vehicle.
21. Make sure that any luggage or objects that could cause injuries in the event of an accident are fastened securely.
22. The cover of the child restraint system should not be replaced with another, unless recommended by the manufacturer, because it is an integral part of the system for securing children!
23. It should be installed in cars for which the manufacturer states in its car owner's manual that the vehicle is suitable for an i-Size Universal child restraint system for this age range.
24. Security is only guaranteed if the child restraint is fitted in accordance with these instructions.
25. For the i-Size enhanced child restraint system, the user must read the instructions manual of the vehicle's manufacturer.
26. Don't use in forward facing before the child reaches the age of 15 months.
27. Do not use rearward facing child seat in seating positions where an active frontal airbag installed. Death or serious injury can occur.
28. It is important to ensure that any lap strap is worn low down, so that the pelvis is firmly engaged.
29. The instruction must be retained on the child restraint for its life period.
30. The hard components or plastic parts of safety device for children should be deployed and installed in way that during everyday use of the vehicle not be jammed by the movable seats or doors. Prevent harness/vehicle belt from getting trapped between car doors or rubbing against sharp parts of the seat or body.
31. All belts that fix the restraint system to the vehicle must be tightened, all belts retaining the child must be adjusted according to the child's body. Twisting of the belts shall not be allowed.
32. Don't use another support point of contact except the ones described in the instructions and marked on the child restraint system.
33. If the child restraint system offers alternative support point of contact and you consider that using that alternative route is not satisfactory, please contact the manufacturer of the child restraint system.
34. Install the car seat in the seating positions indicated in this instruction.
35. Do not use the car seat in the house. It is not designed for home use and should only be used in the vehicle.
36. Before you set any mobile or adjustable part of the child seat, you need to remove your child from the child seat.
37. Check regularly the belts for wearing by paying special attention to the fixing points, the safety guards and the adjusting devices.
38. Do not leave the buckle partially closed, it must be locked when all parts are engaged. You must be able to remove the child from the seat immediately in case of emergency. You have to teach the child not to play with the buckle.
39. Keep the child's chair at a safe place away from children when not in use. Avoid placing heavy objects on the chair. Prevent contact of your vehicle chair with corrosive substances, for example acid from the battery.

## NOTICE

Do NOT install in front seats except in these specific cases:

1. When the car does not have back seats.
  2. When all back seats are occupied by children less than or equal to 135 cm tall.
  3. When it is not possible to install all child restraints in the back seats.
- In seats with: ISOFIX anchorages and Top Tether anchor points and 3-point belt (car's seat belt).

## ATTENTION

The child seat must only be used in this seat IF it has ISOFIX anchorages, top tether points a lap and 3 points belt: diagonal (A) and abdominal (B).

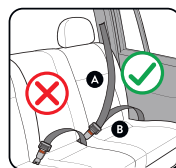
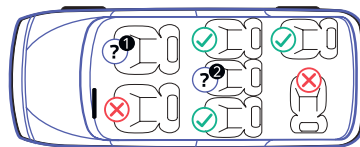

**Produced for Kika Group Ltd., Vasil Levski 121, Plovdiv, Bulgaria. Made in China.**  
**This product complies with ECE R129.**

## I. PARTS

1. Handle of headrest; 2. Headrest; 3. Harness belt; 4. Newborn cushion; 5. Cover for the buckle; 6. Button for the 5-points harness system; 7. Adjustment belt; 8. Indicator for rotation button; 9. Handle for adjusting the angle; 10. Buckle; 11. Shoulder pad; 12. Belt guider; 13. Rotation button; 14. Support leg; 15. Support leg expansion button; 16. Adjustment button for the Support leg; 17. Indicator for the Support leg; 18. ISOFIX attachment second lock; 19. ISOFIX attachment indicator; 20. ISOFIX attachment; 21. Belly strap guide hook; 22. Manual storage

## II. SAFETY WARNING

### 1. NOTICE

Do not to use the ECRS in seating positions where there is an active frontal airbag installed, death or serious injury may occur.\* DO NOT use forward facing before the child's age exceeds 15 months. DO NOT use forward facing before the child's age exceeds 15 months. Read the car manual first and check whether the car seat is equipped with ISOFIX attachment fixed anchor points, and check the size of recommended ISOFIX attachment constraints on the system if it is matched our ISOFIX attachment size.

### 2. POSITION OF THE CAR SEAT ACCORDING TO THE AGE GROUP ( FIGURES 2.1, 2.2, 2.3 )

This is height of 40-150cm product suitable for children from 0-36kg.

	Height	Size	facing direction
2.1.	40-105cm	ISO/R2	rearward facing
2.2.	76-105cm	ISO/F2X	forward facing
2.3.	100-150cm	ISO/B2	

## INSTALLATION POSITION OF THE CAR SEAT IN THE VEHICLE

See Picture 3.1.

### BABY CAR SEAT ISOFIX ATTACHMENT

See Picture 3.2.

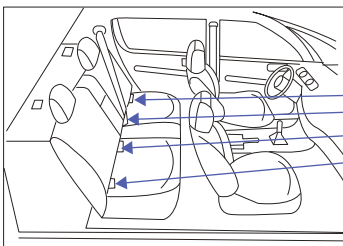

Anchor for the ISOFIX attachment under the seat

## THE ADJUSTMENT AND INSTALLATION OF CHILD SAFETY SEAT / THE USAGE OF BUCKLE

4. Close the left and right latches of the buckle (as shown in Figure 1) and ensure that the concave and convex structures of the left and right latches are closed

4.1. Close the left and right latches without leaving a gap. Keep the latches facing up. (Figure 2)

4.2. Insert the closed latches into the slot of the buckle. (Figure 3)

4.3. If you hear "click" sound, it means that the buckle has been fastened. (Figure 4)

### ADJUST THE SAFETY BELT

Tighten your baby car seat belt Pull the shoulder strap up to tighten the loose part of the leg belt. Then pull the adjustable belt to tighten the belt. Keep your seat belt as tight as possible without causing discomfort. The leg belt should be as low as possible and should be near the crotch, not the belly. A finger space should fit between the seat belt and the child. A loose seat belt is dangerous. Check that the seat belt adjuster is working properly each time when you place a child in a car seat before tightening the seat belt. (Figure 5)

Loose the seat belt. The seat belt can be loosened by pressing the 5-point seat belt adjustment button in front of the seat. While pressing down the 5-point seat belt adjustment button, hold the two straps under the shoulder guard with the other hand and pull them in front of the child to release the seat belt. (Figure 6)

Use the five-point seat belt adjustment button under the front of the seat to loosen the seat belt, unlock the buckle, pull the headrest adjustment handle up, move the headrest to the correct shoulder belt height, and then gently slide the headrest down to check that the headrest is properly hinged. (Figure 7)

Correctly adjusting the headrest can ensure the best protection for your child in the car seat; The headrest must be adjusted to the position that the shoulder strap is compatible with the height of a child's shoulders or slightly higher. The straps must be located at shoulder height or slightly above the child's shoulder height. The shoulder strap should not be behind the child or at or above the ear. (Figure 8)

## ADJUST THE ANGLE RECLINING OF CAR SEAT

The child safety seat can be adjusted to different reclining positions. You can adjust the reclining angle of the seat even when your child is in it.

**REARWARD FACING:** Press the base part of the seat with one hand and pull the angle adjusting handle on the back of the seat with the other hand to adjust the seat to the appropriate position, 5 positions in total. (Figure 10).



*Note: It is important to keep the headrest appropriate to the height of the child's head.*



*When the baby car seat is rearward facing pls use 1,2,3,4,5 position*



EN

# IMPORTANT! KEEP FOR FUTURE REFERENCE! READ CAREFULLY!

**FORWARD FACING (FIGURE 11)** Press the base of the seat with one hand and pull the angle adjusting handle on the back of the seat with the other hand to adjust the seat to the appropriate position, a total of 5 positions.

## NEW BORN CUSHION (FIGURE 12-13)

Place the new born cushion in the car seat, place the two shoulder pads on the new born cushion, and finally cover the buckle cushion on. (Figure 13).

## ROTATION FUNCTION (FIGURE 14 - 16)

1. Take the supporting leg out of the storage at the bottom of the base; 2. Press the supporting leg expansion button and pull out the leg; 3. Press the rotation button and rotate the seat.

## 5-POINT HARNESS SYSTEM TO INSTALL THE CHILD (FIGURES 17-18)

Release the safety belt to the most loosely, then unlock the buckle and place it on both sides of the seat. (Figure 19)  
Insert the left and right latches into the buckle and hear a "click" sound, indicating that the buckle is fastened. Press the adjustable belt button to adjust and tighten the shoulder strap, while ensuring that the child's shoulders are comfortable (a finger space should fit between the seat belt and the child). (Figure 20)

## THE METHOD TO REMOVE THE 5-POINT SEAT BELT SYSTEM (FIGURES 19-26)

1. Pull the strap out which is together with the three-way connection as long as possible and place this position as show. 2. Rotate the Child Restraint System to the back and open the back cover (Figure 20). Figure 21 shows the internal state after opening. 3. Release the shoulder strap from the shoulder clip, and finally pull the shoulder strap and shoulder pad out. 4. Pull out the adjusting strap and release the two shoulder straps from the three-way connection metal clip. (Figure 22) 5. Press the red button to open the buckle. (Figure 23) 6. Pass the buckle (without insertion) through the hole. (Figure 24) 7. Open the upholstery like the picture, fasten the insertion to buckle, open the buckle cover under the base, put the buckle to the buckle hole and finally close the cover. (Figure 25) 8. Clear up the upholstery. (Figure 26).

## INSTALLING METHOD FOR ISOFIX ATTACHMENT (FIGURES 27-31)



**Notice:** Child safety seats can also be used with the ISOFIX attachment guider. (Figure 27)

The installation is more convenient, please clip the ISOFIX attachment guide on the ISOFIX attachment anchor point on the ISOFIX attachment fixed point of the automobile, and the make notch faces upward. (Figure 28)

**Notice:** If your car seat can adjust the angle, pls adjust the car seat angle to the appropriate position, it will be more convenient for ISOFIX attachment installation. (Figure 29)

1. Press ISOFIX attachment lock released button and ISOFIX attachment 2nd lock button (as shown in Figure 30) at the same time, then push ISOFIX attachment out.  
2. Grab the child seat with both hands, then push the two ISOFIX into the ISOFIX guider until the ISOFIX is stuck on both sides, and hear click. When the ISOFIX is locked, pls push the child safety seat vigorously in the direction of the arrow to make it fit the back of the car seat (figure 31).

## REMOVE ISOFIX ATTACHMENT AND HIDE THE SUPPORT LEG (FIGURE 32-33) REMOVING THE ISOFIX ATTACHMENT

1. Press the "ISOFIX attachment unlock button", and hear "click" sound, ensure that both sides of the ISOFIX attachment are unlocked, then remove the seat. (Figure 32)



**Notice:** ISOFIX attachment is unlocked correctly only when the left and right ISOFIX indicator show red.

## HIDE THE SUPPORT LEG

1. Press the supporting leg adjustment button and pull the Support leg up. (Figure 33)

## RELEASE AND STORAGE OF SUPPORT LEGS. RELEASE OF SUPPORT LEG. (FIGURES 34-35)

1. Put the bottom of the seat in the displayed state as shown in the figure, and take out the supporting legs from the storage bin at the bottom of the base. (Figure 34)

2. Press the expansion button of the supporting leg inward with your hand, and pull the supporting leg outwards. (Figure 35)

Storage of the support leg according to the reverse operation of the release of the support leg, press Figure 35 and then press Figure 34 to reverse the operation

The operation is OK.

## INSTALLATION OF SUPPORT LEG (FIGURES 36-37)

1. Take the Support leg out from the storage bin at the bottom of the base 2. Press the expansion button to pull the support leg out 3. Place child in car seat and secure with 5-point seat belt system



**Notice:** 1. Check and tighten ISOFIX attachment, Support leg and 5-point seat belt system to ensure seat and child are firmly fixed.

2. The 5-point seat belt should not be twisted or wound. 3. When installing the car seat by rearward facing and children's height is less than 75cm, it must use new

born cushion. 4. We recommend to install car seat with ISOFIX attachment guider. 5. The seat must be as close to (against) the back of the vehicle seat as possible

6. The child restraint system should not be installed in the position where the airbag is installed in the rearward facing position. The 100-150cm I-Size Booster seat cannot use the Support leg. (Figure 37)

## INSTALLATION METHOD | MAKING REARWARD FACING POSITION BY USING ISOFIX ATTACHMENT+ SUPPORT LEG (SUITABLE FOR

### CHILDREN HEIGHT FROM 40-105CM) (FIGURES 38 - 39)

1. When installing the child safety seat in the rearward facing position, take the Support leg out from the bottom of the seat and then rotate the seat to the rearward position (see Figure 37). Then install the ISOFIX attachment to the car seat firmly. 2. Press the supporting leg adjustment button by your hand and pull the Support leg down until it touches the car surface. (Figure 39) 3. Place the child in car seat and secure with 5-point seat belt system.



**Attention!** If your child's height is less than 105cm, please use rearward facing.



**Attention:** When the supporting leg touches the car surface, the support leg indicator must be all green (as shown in the figure).

**Warning:** This child car seat must not be used in a vehicle seat where airbag has been activated.

## INSTALLING THE CHILD SAFETY SEAT FORWARD FACING POSITION BY USING ISOFIX ATTACHMENT+ SUPPORT LEG (SUITABLE FOR CHILDREN HEIGHT FROM 76-105CM) (FIGURES 40-41)

1. When installing the child safety seat in the forward facing position, take the Support leg out from the bottom of the seat and then rotate the seat to the forward position. (see Figure 40). Install the ISOFIX attachment to the car seat firmly. 2. Press the Support leg adjustment button by your hand and pull the Support leg down until it touches the car surface 3. Place the child in car seat and secure with 5-point seat belt system.

**Attention!** When the Support leg touches the car surface, the Support leg indicator must be all green (as shown in the figure).

## INSTALLING THE CAR SEAT FORWARD FACING POSITION BY USING ISOFIX ATTACHMENT+ 3-POINT SEAT BELT (SUITABLE FOR CHILDREN HEIGHT FROM 100-150CM) (FIGURES 42-44)

1. Remove the 5-point safety belt system before placing the child in this way. 2. Fasten the car seat through ISOFIX attachment and ISOFIX attachment anchor points on the vehicle seat.

3. Place the child seat on the vehicle seat and adjust the seat to the appropriate position. 4. The vehicle seat belt passes through the belt guider and pass the child's shoulder.

5. Vehicle seat abdominal belt through the belt guider and pass the child's pelvis. 6. Fasten your car seat belt.



**The 100-150cm I-Size Booster seat cannot use the Support leg. (Figure 44)**

## USE 3-POINT SEAT BELT TO INSTALL THE CHILD SAFETY SEAT IN FORWARD FACING POSITION (SUITABLE FOR CHILDREN HEIGHT FROM 100-150CM) (FIGURES 42-44)

1. Remove the 5-point safety belt system before placing the child in this way.

2. Place the child seat on the vehicle seat and adjust the seat to the appropriate position.

3. The vehicle seat belt passes through the belt guider and pass the child's shoulder.

4. Vehicle seat abdominal belt through the belt guider and pass the child's pelvis.

5. Fasten your car seat belt.

## REMOVAL AND INSTALLATION OF CLOTH COVER | REMOVAL OF THE CLOTH COVER (FIGURES 45-46)

1. Adjust the shoulder straps. (See 01)

2. Press the red button A on the buckle to open the buckle. (See 03)

3. Take out the inner liner (See 02) and snap pad (See 04)

4. Carefully remove the headrest cover and seat cover from the seat.

## CLEANING AND MAINTENANCE (FIGURE 47)

In the daily using, it is necessary to regularly check the child safety seat.

In case of accident, the safety seat must be replaced.

When the car seat is not in use, the child safety seat should be placed in a dry and ventilated place to avoid damp and mildew.

If there is dust on the surface of the child safety seat, we can use a damp sponge to wipe and ventilate it to dry.

If food or drink drops onto the seat belt by accident, pls remove the seat belt and rinse thoroughly with warm water and ventilate it to dry.

To clean the entire seat cover, please refer to the washing instructions.

Slight fading may occur during the first washing, which it is a normal situation.