

 **kikka boo**

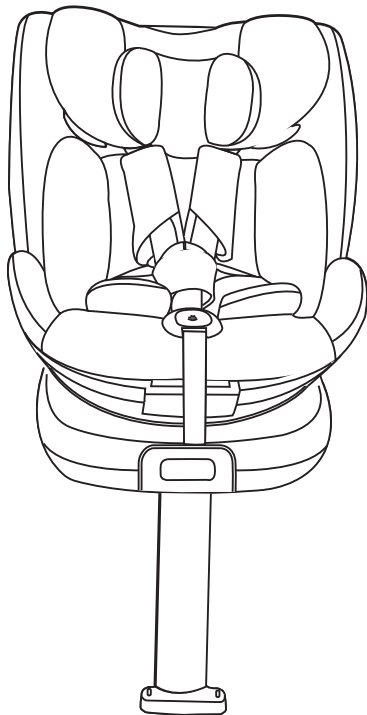

40-150cm

**i-ORBIT** 

car seat  
i-SIZE

<b>EN</b>	INSTRUCTIONS FOR USE	<b>BS</b>	UPUTSTVO ZA UPOTREBU
<b>ES</b>	INSTRUCCIONES DE USO	<b>KA</b>	გამოყენების ინსტრუქცია
<b>BG</b>	ИНСТРУКЦИИ ЗА УПОТРЕБА	<b>ME</b>	UPUTE ZA UPOTREBU
<b>IT</b>	ISTRUZIONI D'USO	<b>UA</b>	ІНСТРУКЦІЯ З ВИКОРИСТАННЯ
<b>GR</b>	ΟΔΗΓΙΕΣ ΧΡΗΣΗΣ	<b>HR</b>	UPUTE ZA UPORABU
<b>DE</b>	GEBRAUCHSANWEISUNG	<b>CZ</b>	NÁVOD K POUŽITÍ
<b>FR</b>	MODE D'EMPLOI	<b>SK</b>	NÁVOD NA POUŽITIE
<b>NL</b>	GEBRUIKSAANWIJZING	<b>SL</b>	NAVODILA ZA UPORABO
<b>FI</b>	KÄYTTÖOHJEET	<b>HU</b>	HASZNÁLATI UTASÍTÁS
<b>RO</b>	INSTRUCȚIUNI DE UTILIZARE	<b>HY</b>	ՕԳՏԱԳՈՐԾՄԱՆ ՑՈՒՑՈՒՄՆԵՐ
<b>PT</b>	INSTRUÇÕES DE USO	<b>ET</b>	KASUTUSJUHEND
<b>MT</b>	ISTRUZZJONIJIET GĦALL-UŻU	<b>LT</b>	NAUDOJIMO INSTRUKCIJA
<b>PL</b>	INSTRUKCJA UŻYTKOWANIA	<b>LV</b>	LIETOŠANAS INSTRUKCIJA
<b>SR</b>	УПУТСТВО ЗА УПОТРЕБУ	<b>FA</b>	دستور العمل استفاده
<b>MK</b>	УПАТСТВА ЗА УПОТРЕБА	<b>AR</b>	تعليمات الاستخدام
<b>AL</b>	UDHËZIMET E PËRDORIMIT		



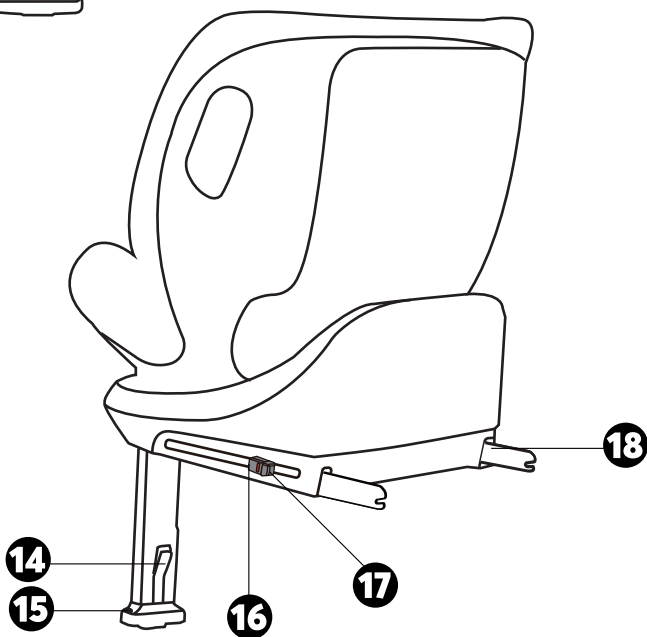
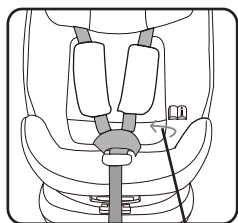
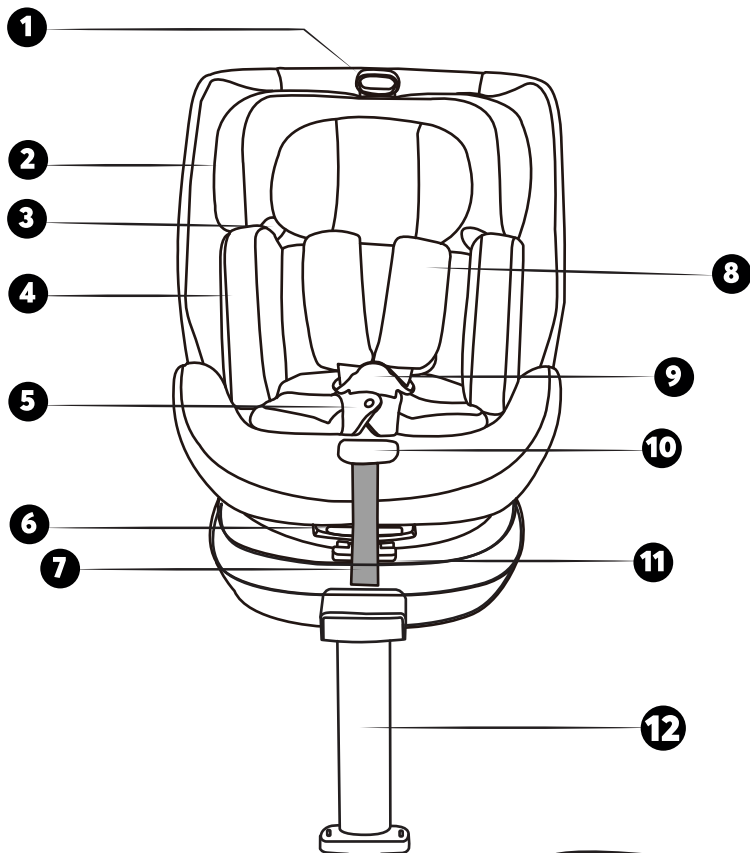
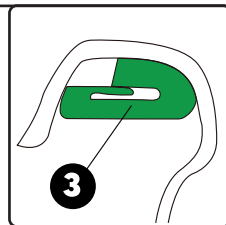

1

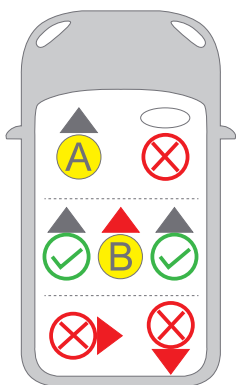
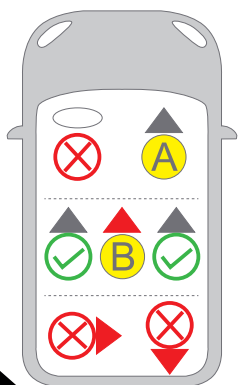

II.

2

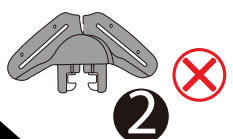
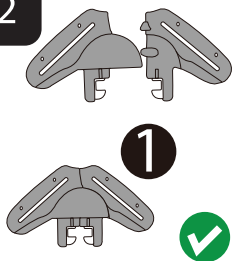

3

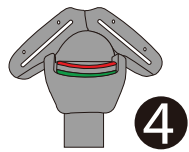
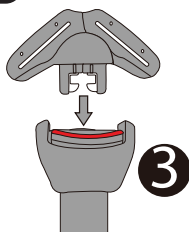

4



III.

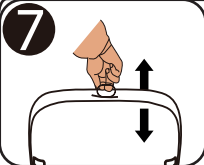

9

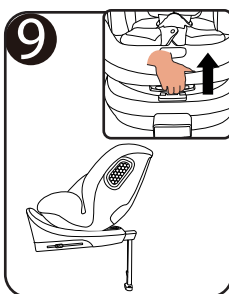

10

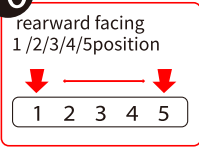

11



IV.

V.

12

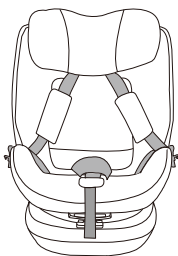
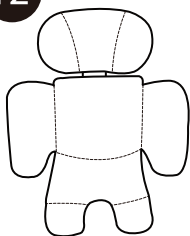

13

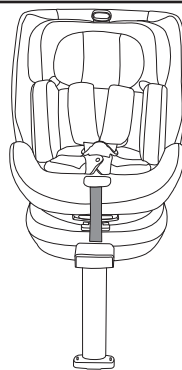

VI.

14

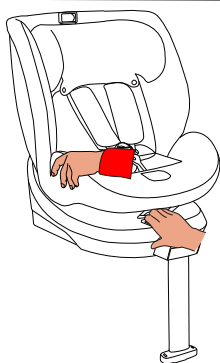

15

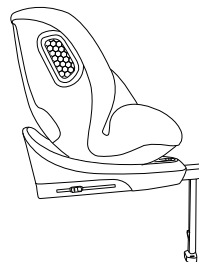
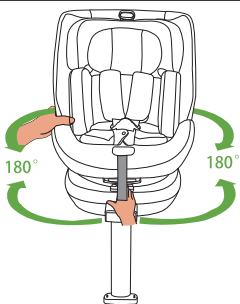

VII.

16

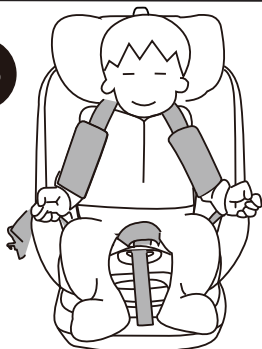

17

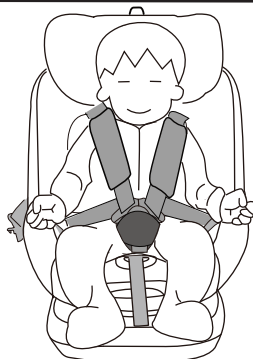

VIII.

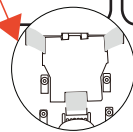
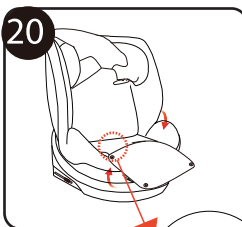
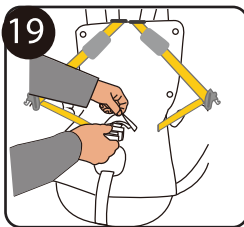
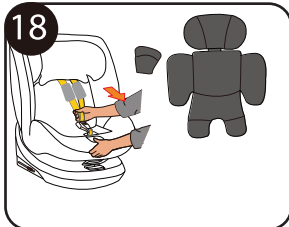

IX.

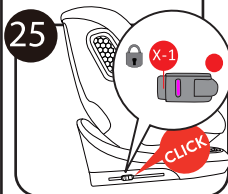
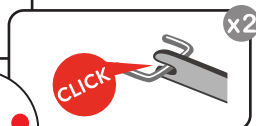
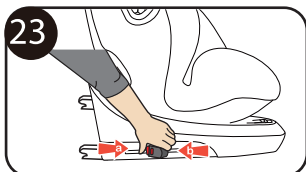
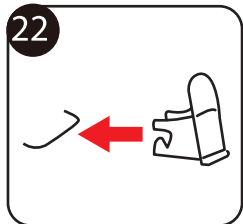

X.

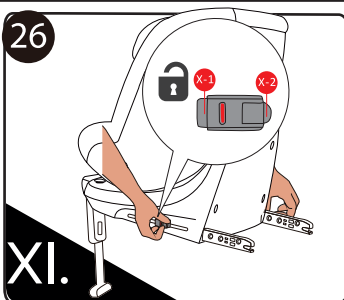

XI.

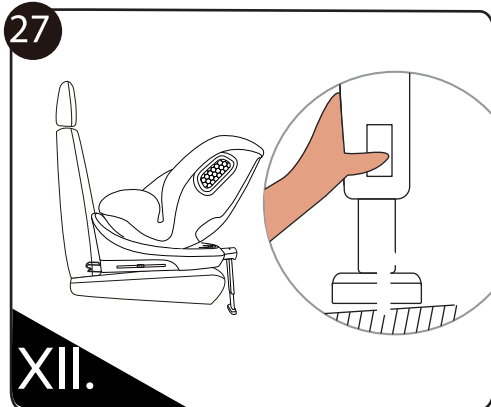

XII.

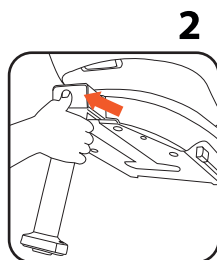

XIII.

29

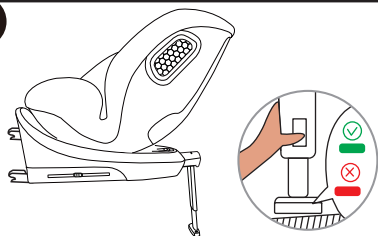

30

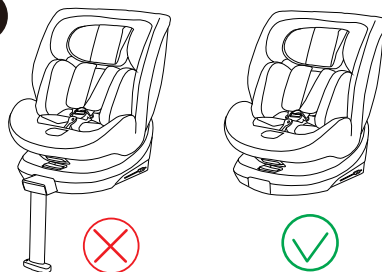

XIV.

31



32



33



34

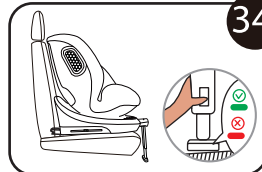

35

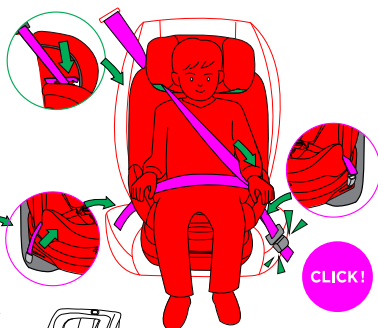

36

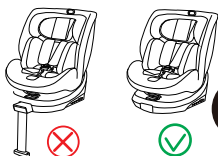
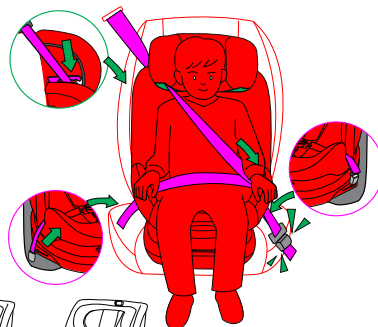

35-1

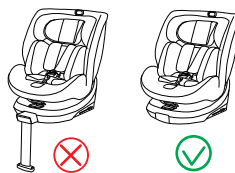

36-1

XV.

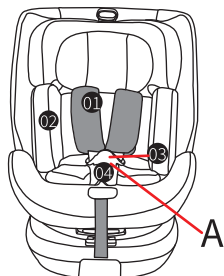

XVI.

# IMPORTANT! KEEP FOR FUTURE REFERENCE! READ CAREFULLY!

The instructions for use must be kept for the entire life of the universal child restraint system.

## WARNING!

1. This car seat provides optimal safety in all installation positions for which it was designed.
2. This is an i-Size Enhanced Child Restraint System (40-105cm). It is approved pursuant to European Regulation 129 (ECE R129), for use in i-Size compatible car seats as indicated by manufacturers in the car owner's manual. If you have questions, please consult either the Enhanced Child Restraint System manufacturer or the distributor.
3. This is an i-Size booster Enhanced Child Restraint System (100-135cm). It is approved according to ECE R129, for use in i-Size compatible seats, as indicated by the manufacturer in the car owner's manual. If you have questions, please consult either the Enhanced Child Restraint System manufacturer or the distributor.
4. This is a booster seat for specific cars (135-150cm) and is an Enhanced Child Restraint System. It is approved according to European Regulation R129, for use in specific cars detailed in the applicable vehicle list. If you have questions, please consult either the Enhanced Child Restraint System manufacturer or the retailer.
5. This is an i-Size Universal child restraint system, approved pursuant to European ECE R129, for its general use in cars, although it is not suitable for all cars.
6. It should be installed in cars for which the manufacturer states in its car owner's manual that the vehicle is suitable for an i-Size Universal child restraint system for this age range.
7. The product has been approved pursuant to European regulation ECE R129 and can be used for heights between 40 and 150 cm and maximum weight 36 kg.
8. Make sure that the buckle is correctly fastened before starting to drive.
9. Any straps holding the restraint to the vehicle should be tight, that any support-leg should be in contact with the vehicle floor, that any straps or impact shields restraining the child should be adjusted to the child's body, and that straps should not be twisted.
10. Ensure that any strap or belt that holds the child is not folded or twisted and remains tightened.
11. Ensure that the abdominal belt or strap rests as low as possible over the child's hips, on both sides.
12. In the event of an accident, even if there are no apparent damages, the seat may be unsafe. The seat should be replaced after being subjected to the sudden and strong stresses associated with an accident.
13. Instruction illustrations are for informational purposes only. The child restraint system may contain small differences compared to the photographs or images in the instructions manual. These variations do not affect its approval by Regulation ECE R129.
14. Under no circumstances should the car seat be installed in the car's passenger seat opposite the direction of travel if there is an active airbag.
15. Please read the instructions carefully, as incorrect installation could result in serious injury. In this case, the manufacturer shall not be held liable.
16. Ensure that all the locking devices are engaged before use.
17. It is dangerous to undertake any changes or additions to the safety seat with approval from the competent authority. It is dangerous to not strictly follow the installation instructions provided by the child car seat manufacturer.
18. Please never use the safety seat without its cover or without the harness protectors.
19. Make sure to protect the child safety seat from direct sunlight as it could heat up and hurt the child.
20. The car seat should remain permanently installed in the vehicle, even when the child is not in it. Never leave the child unattended when sitting in the car seat, even when the seat is outside the vehicle.
21. Make sure that any luggage or objects that could cause injuries in the event of an accident are fastened securely.
22. The cover of the child restraint system should not be replaced with another, unless recommended by the manufacturer, because it is an integral part of the system for securing children!
23. It should be installed in cars for which the manufacturer states in its car owner's manual that the vehicle is suitable for an i-Size Universal child restraint system for this age range.
24. Security is only guaranteed if the child restraint is fitted in accordance with these instructions.
25. For the i-Size enhanced child restraint system, the user must read the instructions manual of the vehicle's manufacturer.
26. Don't use in forward facing before the child reaches the age of 15 months.
27. Do not use rearward facing child seat in seating positions where an active frontal airbag installed. Death or serious injury can occur.
28. It is important to ensure that any lap strap is worn low down, so that the pelvis is firmly engaged.
29. The instruction must be retained on the child restraint for its life period.
30. The hard components or plastic parts of safety device for children should be deployed and installed in way that during everyday use of the vehicle not be jammed by the movable seats or doors. Prevent harness/vehicle belt from getting trapped between car doors or rubbing against sharp parts of the seat or body.
31. All belts that fix the restraint system to the vehicle must be tightened, all belts retaining the child must be adjusted according to the child's body. Twisting of the belts shall not be allowed.
32. Don't use another support point of contact except the ones described in the instructions and marked on the child restraint system.
33. If the child restraint system offers alternative support point of contact and you consider that using that alternative route is not satisfactory, please contact the manufacturer of the child restraint system.
34. Install the car seat in the seating positions indicated in this instruction.
35. Do not use the car seat in the house. It is not designed for home use and should only be used in the vehicle.
36. Before you set any mobile or adjustable part of the child seat, you need to remove your child from the child seat.
37. Check regularly the belts for wearing by paying special attention to the fixing points, the safety guards and the adjusting devices.
38. Do not leave the buckle partially closed, it must be locked when all parts are engaged. You must be able to remove the child from the seat immediately in case of emergency. You have to teach the child not to play with the buckle.
39. Keep the child's chair at a safe place away from children when not in use. Avoid placing heavy objects on the chair. Prevent contact of your vehicle chair with corrosive substances, for example acid from the battery.

Produced for Kika Group Ltd., Vasil Levski 121, Plovdiv, Bulgaria. Made in China.

This product complies with ECE R129.

## NOTICE

Do NOT install in front seats except in these specific cases:

1. When the car does not have back seats.
  2. When all back seats are occupied by children less than or equal to 135 cm tall.
  3. When it is not possible to install all child restraints in the back seats.
- In seats with: ISOFIX anchorages and Top Tether anchor points and 3-point belt (car's seat belt).

## ATTENTION

The child seat must only be used in this seat IF it has ISOFIX anchorages, top tether points a lap and 3 point belt: diagonal (A) and abdominal (B).

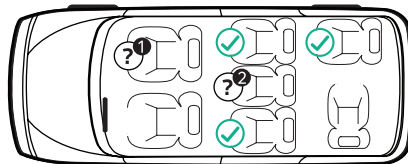

	Height	Size	FACING DIRECTION
	40-105cm	ISO/R2	rearward facing
	76-105cm	ISO/F2X	forward facing
	100-150cm	ISO/B2	

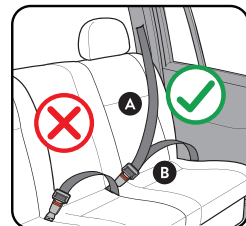



# IMPORTANT! KEEP FOR FUTURE REFERENCE! READ CAREFULLY!

## I. PARTS

1. Handle For The Headrest; 2. Headrest; 3. Belt Guider; 4. Newborn Cushion; 5. Buckle Pads; 6. Handle For Adjusting The Angle; 7. Adjustment Belt; 8. Shoulder Pads; 9. Buckle; 10. Button For The 5-points Harness System; 11. Rotation Adjusting Handle; 12. Support Leg; 13. Instruction storage bag; 14. Supporting Leg Adjustment Button; 15. Supporting Leg Indicator; 16. ISOFIX Attachment Second Lock; 17. ISOFIX Attachment Release Button; 18. Attachment

## II. BABY CAR SEAT ISOFIX POSITION & ATTACHMENT

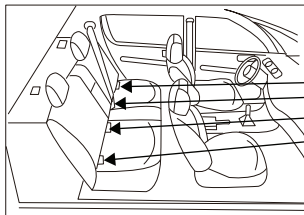

**ANCHOR FOR THE ISOFIX  
ATTACHMENT UNDER THE SEAT**

## III. ADJUSTMENT AND INSTALLATION OF CHILD SAFETY SEAT | THE USAGE OF BUCKLE AND SEAT BELT:

SCHEME 2 > 1. Close the left and right latches of the buckle (as shown in Figure 1) and ensure that the concave and convex structures of the left and right latches are closed; 2. Close the left and right latches without leaving a gap. Keep the latches facing up. (Figure 2)

SCHEME 3 > 3. Insert the dosed latches into the slot of the buckle. (Figure 3) 4. If you hear "click" sound, it means that the buckle has been fastened. (Figure 4)

### SCHEME 4 > ADJUST THE SAFETY BELT

#### 1. TIGHTENING THE BABY CAR SEAT BELT

Pull the shoulder strap up to tighten the loose part of the leg belt. Then pull the adjustable belt to tighten the belt.

Keep your seat belt as tight as possible without causing discomfort. The leg belt should be as low as possible and should be near the crotch, not the belly.

A loose seat belt is dangerous. Check that the seat belt adjuster is working properly each time when you place a child in a car seat before tightening the seat belt. A finger space should fit between the seat belt and the child. (Figure 5) A loose seat belt is dangerous. Check that the seat belt adjuster is working properly each time when you place a child in a car seat before tightening the seat belt.

#### LOOSING THE SEAT BELT

The belt can be loosened by pressing the five-point belt adjuster in front of the seat. Press down on the five-point belt adjuster while holding the two shoulder straps under the shoulder pads with your other hand and pulling them directly in front of your child to release the belts. (Figure 6)

## IV. ADJUSTING THE HEIGHT OF HEADREST

1. Adjust the seat belt to the loosest through the five-point belt adjuster under the cloth cover in front of the seat, unfasten the buckle, pull the headrest handle upward, move the headrest to the correct shoulder strap height position, and then check whether the headrest is properly engaged by gently sliding the headrest down. (Figure 7)

2. Correctly adjusting the headrest can ensure the best protection for your child in the car seat; The headrest must be adjusted to the position that the shoulder strap is compatible with the height of a child's shoulders or slightly higher. The straps must be located at shoulder height or slightly above the child's shoulder height. The shoulder strap should not be behind the child or at or above the ear. (Figure 8)

NOTE: IT IS IMPORTANT TO KEEP THE HEADREST APPROPRIATE TO THE HEIGHT OF THE CHILD'S HEAD.

## V. ADJUST THE ANGLE RECLINING OF CAR SEAT

The child safety seat can be adjusted to different reclining positions. You can adjust the reclining angle of the seat even when your child is in it. (Figure 9)

**REARWARD FACING:** Press the base part of the seat with one hand and pull the angle adjusting handle on the back of the seat with the other hand to adjust the seat to the appropriate position, 5 positions in total. When the baby car seat is rearward facing; pls use 1,2,3,4,5 position. (Figure 10)

**FORWARD FACING:** Press the base of the seat with one hand and pull the angle adjusting handle on the back of the seat with the other hand to adjust the seat to the appropriate position, a total of 5 positions. When the baby car seat is forward facing please use 1,2,3,4,5 position. (Figure 11)

## VI. NEW BORN CUSHION

NOTICE: WHEN THE HEIGHT OF BABY IS 40-75CM, PLEASE USE THE NEWBORN BABY'S CUSHION. (Figure 12)

Place the new born cushion in the car seat, place the two shoulder pads on the new born cushion, and finally cover the buckle cushion on. (Figure 13)

## VII. ROTATION FUNCTION

1. Take the supporting leg out of the storage at the bottom of the base;

2. Press the supporting leg expansion button and pull out the leg;

3. Press the rotation button and rotate the seat. (Figure 14)

ATTENTION !BEFORE EACH TRIP PLEASE MAKE SURE THAT THE SEAT ROTATION IS LOCKED BY TURNING THE SEAT IN BOTH DIRECTIONS.

"IMPORTANT-DO NOT USE FORWARD FACING BEFORE THE CHILD'S AGE EXCEEDS 15 MONTHS(REFER TO INSTRUCTION)"

ATTENTION!BEFORE EACH TRIP, PLS MAKE SURE THE CHILD SEAT IS IN THE CORRECT GROUP AND CONFIGURATION. (Figure 15)

## VIII. 5-POINT HARNESS SYSTEM TO INSTALL THE CHILD

1. Release the safety belt to the most loosely, then unlock the buckle and place it on both sides of the seat, as shown in the picture (Figure 16)

2. Insert the left and right latches into the buckle and hear a "click" sound, indicating that the buckle is fastened. Press the adjustable belt button to adjust and tighten the shoulder strap, while ensuring that the child's shoulders are comfortable (a finger space should fit between the seat belt and the child). (Figure 17)

## IX. HOW TO HIDE THE FIVE-POINT SAFETY BELT

1. Remove shoulder pads, buckle cover and new born cushion from the seat. (Figure 18)

2. Pass the buckle through the hole in the cloth sleeve. (Figure 19)

3. Open the buttons of the seat cloth cover as shown. Insert the latches insert into the buckle. Open the buckle cover at the bottom of the seat, place the buckle in, and finally close the cover. (Figure 20)

4. Tidy up the doth cover. (Figure 21)

## X. INSTALLING METHOD FOR ISOFIX ATTACHMENT

NOTICE: Child safety seats can also be used with the ISOFIX attachment guider.

The installation is more convenient, please dip the ISOFIX attachment guide on the ISOFIX attachment anchor point on the ISOFIX attachment fixed point of the automobile.

Note: If your car seat back angle is adjustable, you can adjust the car seat angle to the appropriate position to make it easier to install the child seat ISOFIX attachment.

1. Press and hold the ISOFIX attachment release button and the ISOFIX attachment second lock button at the same time (as shown in Figure 23), and then push the ISOFIX attachment interface to the outermost edge. Tip: Only when the left and right; ISOFIX attachment release buttons appear in green pattern It shows that ISOFIX attachment has been locked.

2. Grab the child seat with both hands, then push the two ISOFIX into the ISOFIX guider until the ISOFIX is stuck on both sides, and hear click. When the ISOFIX is locked, pls push the child safety seat vigorously in the direction of the arrow to make it fit the back of the car seat (Figure 25).

## XI. REMOVING THE ISOFIX

1.1. Press the "ISOFIX attachment unlock button", and hear "click" sound, ensure that both sides of the ISOFIX attachment are unlocked, then remove the seat ( Figure 26 )

## XII. HIDING THE SUPPORT LEG

1. Press the supporting leg adjustment button and pull the Support leg up ( Figure 27 )

## XIII. RELEASE AND STORAGE OF SUPPORT LEGS | RELEASE OF SUPPORT LEG

1. Put the bottom of the seat in the displayed state as shown in the figure, and take out the supporting legs from the storage bin at the bottom of the base. ( Figure 28 )

## SUPPORT LEG STORAGE

1. Support leg storage According to the reverse operation of the release of the support leg, press figure 25, then press Figure 24 reverse operation

The operation is OK.

## XIV. INSTALLATION OF SUPPORT LEG

Notice: when the Support leg touches the car surface, the Support leg indicator must be all green (as shown in the figure 29)

1. Take the Support leg out from the storage bin at the bottom of the base

2. Press the expansion button to pull the support leg out

3. Place child in car seat and secure with 5-point seat belt system

Notice: 1. Check and tighten ISOFIX attachment, Support leg and 5-point seat belt system to ensure seat and child are firmly fixed.

2. The 5-point seat belt should not be twisted or wound.

3. When installing the car seat by rearward facing and children's height is less than 75cm, it must use new born cushion.

4. We recommend to install car seat with ISOFIX attachment guider.

5. The seat must be as close to (against) the back of the vehicle seat as possible

6. The child restraint system should not be installed in the position where the airbag is installed in the rearward facing position.

**The 100-150cm I-Size Booster seat cannot use the Support leg.** ( See Figure 30 )

## XV. 1. INSTALLATION METHOD | 5-1 MAKING REARWARD FACING POSITION BY USING ISOFIX ATTACHMENT+ SUPPORT LEG (SUITABLE FOR CHILDREN HEIGHT FROM 40-105CM)

(see Figure 31) 1. When installing the child safety seat in the forward facing position, take the Support leg out from the bottom of the seat according to the instructions in chapter XI, and then rotate the seat to the rearward position according to the instructions in chapter VII (see Figure 14). Then according to the instructions in chapter X install the ISOFIX attachment to the car seat firmly.

**ATTENTION! IF YOUR CHILD'S HEIGHT IS LESS THAN 105CM, PLEASE USE REARWARD FACING.**

**WARNING: THIS CHILD CAR SEAT MUST NOT BE USED IN A VEHICLE SEAT WHERE AIRBAG HAS BEEN ACTIVATED.**

(see Figure 32) 2. Press the supporting leg adjustment button by your hand and pull the Support leg down until it touches the car surface

3. Place the child in car seat and secure with 5-point seat belt system.

**ATTENTION: WHEN THE SUPPORTING LEG TOUCHES THE CAR SURFACE, THE SUPPORT LEG INDICATOR MUST BE ALL GREEN (AS SHOWN IN THE FIGURE).**

## 2. INSTALLING THE CHILD SAFETY SEAT FORWARD FACING POSITION BY USING ISOFIX ATTACHMENT+ SUPPORT LEG (SUITABLE FOR CHILDREN HEIGHT FROM 76-105CM)

(see Figure 33) 1. When installing the child safety seat in the forward facing position, take the Support leg out from the bottom of the seat according to the instructions in chapter XI, and then rotate the seat to the forward position according to the instructions in chapter VII (see Figure 14). Then according to the instructions in chapter X install the ISOFIX attachment to the car seat firmly.

(see Figure 34) 2. Press the Support leg adjustment button by your hand and pull the Support leg down until it touches the car surface

3. Place the child in car seat and secure with 5-point seat belt system.

**ATTENTION: WHEN THE SUPPORT LEG TOUCHES THE CAR SURFACE, THE SUPPORT LEG INDICATOR MUST BE ALL GREEN (AS SHOWN IN THE FIGURE).**

## 3. INSTALLING THE CAR SEAT FORWARD FACING POSITION BY USING ISOFIX ATTACHMENT+ 3-POINT SEAT BELT (SUITABLE FOR CHILDREN WITH HEIGHT FROM 100-150CM)

1. Remove the 5-point safety belt system before placing the child in this way (see Chapter IX) 2. Fasten the car seat through ISOFIX attachment and ISOFIX attachment anchor points on the vehicle seat according to instructions in Chapter X. 3. Place the child seat on the vehicle seat and adjust the seat to the appropriate position (see instructions in Chapter V). 4. The vehicle seat belt passes through the belt guider and pass the child's shoulder 5. Vehicle seat abdominal belt through the belt guider and pass the child's pelvis 6. Fasten your car seat belt (See Figure 35)

**The 100-150cm I-Size Booster seat cannot use the Support leg.** (See Figure 35-1)

## 4. USE 3-POINT SEAT BELT TO INSTALL THE CHILD SAFETY SEAT IN FORWARD FACING POSITION (SUITABLE FOR CHILDREN HEIGHT FROM 100-150CM)

1. Remove the 5-point safety belt system before placing the child in this way (see Chapter IX) 2. Place the child seat on the vehicle seat and adjust the seat to the appropriate position

(see Chapter V). 3. The vehicle seat belt passes through the belt guider and pass the child's shoulder 4. Vehicle seat abdominal belt through the belt guider and pass the child's pelvis 5. Fasten your car seat belt (See Figure 36)

**The 100-150cm I-Size Booster seat cannot use the Support leg.** (See Figure 36-1)

## XVI. INSTALLATION OF CLOTH COVER

**REMOVAL OF THE CLOTH COVER (SEE FIGURE 33)**

1. Adjust the shoulder straps ①

2. Press the red button A on the buckle to open the buckle ③

3. Take out the inner liner ② and snap pad ④

4. Carefully remove the headrest cover and seat cover from the seat.

## CLEANING AND MAINTENANCE

In the daily using, it is necessary to regularly check the child safety seat,

In case of accident, the safety seat must be replaced.

When the car seat is not in use, the child safety seat should be placed in a dry and ventilated place to avoid damp and mildew.

If there is dust on the surface of the child safety seat, we can use a damp sponge to wipe and ventilate it to dry.

If food or drink drops onto the seat belt by accident, pls remove the seat belt and rinse thoroughly with warm water and ventilate it to dry.

To clean the entire seat cover, please refer to the washing instructions.

Slight fading may occur during the first washing, which it is a normal situation.

## WASHING INSTRUCTIONS FOR THE TEXTILE COVER:

HAND WASH WITH WATER TEMPERATURE OF MAX 30°C, DO NOT WASH IN WASHING MACHINE, DO NOT BLEACH, DO NOT TUMBLE DRY, DO NOT IRON, DO NOT USE ABRASIVES AND AGGRESSIVE

DETERGENTS. USE SOFT SOAP AND CARING DETERGENT ONLY. DRY IN AIRY AND OPEN PLACE. AVOID DRYING UNDER DIRECT INTENSE SUNLIGHT.

